

ROTARY DRILLING RIG ZR250C



ZOOMLION

Zoomlion Heavy Industry Science & Technology Co.,Ltd.

Add:Zoomlion Overseas Building, No.613, 3rd Section, Furong Middle Road, Yuhua District, Changsha, Hunan, P.R.China 410205

Copyright © 2015 Zoomlion. All rights reserved. Reproduction and copying of any part of the Contents is not allowed for any purposes without Zoomlion's written approval.
Note: No product coating appearance shall be subject to sample.



ZOOMLION

Features

- 1. World-class components are used to achieve excellent performance;
- 2. The world advanced load-sensing, proportionally-controlled hydraulic systems using efficient cooling methods help to achieve high efficiency and energy saving;
- 3. As many as 11 track rollers allow the ground pressure to be more even; large-pitch crawlers and travel systems allow the undercarriage to be stronger;
- 4. Optimized four-hinge luffing mechanism and large-diameter high-strength pin joints make the machine more reliable and safe.
- 5. The mast uses a large-arc bending-forming structure with high strength, light weight and good stiffness. The unique separate lubrication path and anti-seize mechanism of the mast turntable make the machine operation more stable and extend the machine life.

Technical Data

NAME		SPEC.
Torque(KN.M)		250
Drilling Diameter(mm)		2500
Drilling Depth(m)	inter-locking	56
	Friction	84
Drilling Speed(r/min)		6-24
Engine Model		Cummins QSL9
Rated Power(kw)		242
Rated Engine Speed(r/min)		2000
Max.Crowd Force(kN)		200
Max.Crowd Cylinder Pull(kN)		220
Line Pull(main winch)(kN)		274
Line Speed(main winch)(m/min)		68
Line Pull(aux.winch)(kN)		90
Line Speed(aux.winch)(m/min)		66
Operating Mass(t)		85
Traction Force(kN)		423
Diesel Tank(L)		600
Rope diameter (Main winch) (mm)		32
Rope diameter (auxiliary winch) (mm)		22

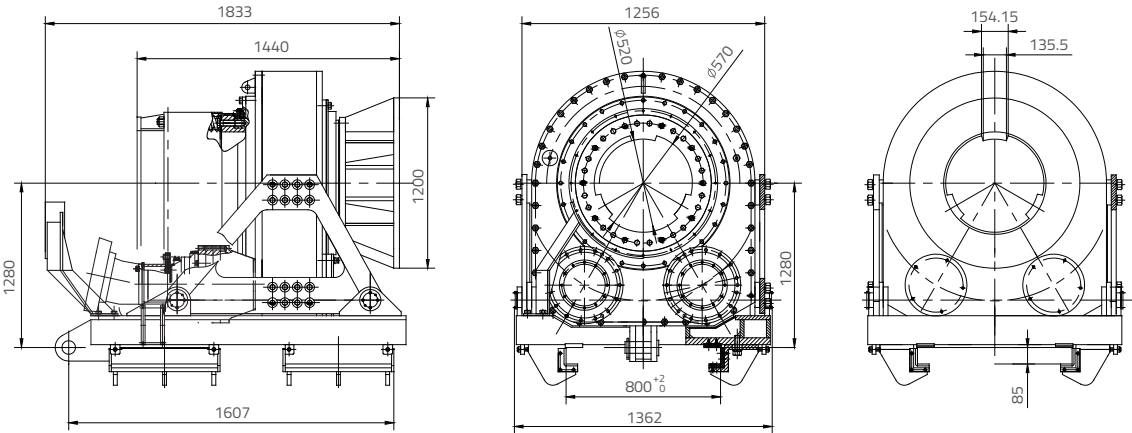

Overall Dimensions (Unit: mm)

