

# ROTARY DRILLING RIG ZR220C



**ZOOMLION**

Zoomlion Heavy Industry Science & Technology Co.,Ltd.

Add:Zoomlion Overseas Building, No.613, 3rd Section, Furong Middle Road, Yuhua District, Changsha, Hunan, P.R.China 410205

Copyright © 2015 Zoomlion. All rights reserved. Reproduction and copying of any part of the Contents is not allowed for any purposes without Zoomlion's written approval.  
Note: No product coating appearance shall be subject to sample.



**ZOOMLION**

Features

- 1. Zoomlion's specific-use in-house telescopic-crawler undercarriage is used to achieve superior stability and transport convenience.
- 2. The over-loading proof device of the crowding system can protect the Kelly bar effectively and fully make use of capacity of the machine to ensure verticality of the borehole.
- 3. Pilot and proportionally controlled hydraulic systems, load-sensing or negative-flow controlled main pump or auxiliary pump systems with high control accuracy help to achieve high efficiency and less energy loss;
- 4. Zoomlion's patented high-accuracy depth measurement device whose accuracy is several times better than domestic or international competitions is used for automatic measurement;
- 5. Drilling tools for different purposes with different specifications such as long or short augers, generic-use drilling buckets and core barrels, etc, are equipped to satisfy construction requirements in different geological conditions

Technical Data

NAME		SPEC.
Torque(KN.M)		220
Drilling Diameter(mm)		2000
Drilling Depth(m)	inter-locking	56
	Friction	70
Drilling Speed(r/min)		7-26
Engine Model		Cummins QSL9
Rated Power(kw)		242
Rated Engine Speed(r/min)		2000
Max.Crowd Force(kN)		180
Max.Crowd Cylinder Pull(kN)		200
Line Pull(main winch)(kN)		220
Line Speed(main winch)(m/min)		70
Line Pull(aux.winch)(kN)		110
Line Speed(aux.winch)(m/min)		66
Operating Mass(t)		80
Traction Force(kN)		423
Diesel Tank(L)		600
Rope diameter（Main winch）（mm）		32
Rope diameter（auxiliary winch）（mm）		22

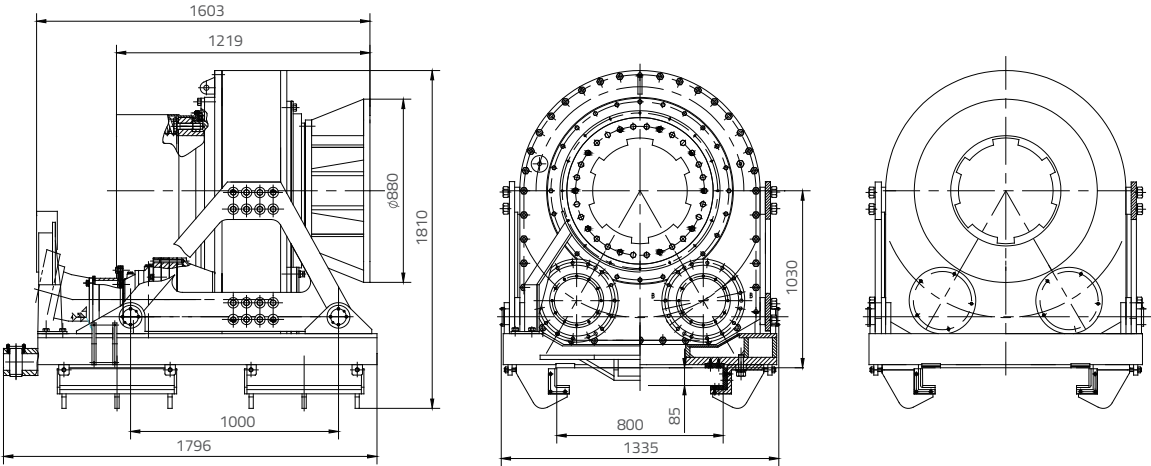

Overall Dimensions (Unit: mm)

